

SOPRAS

s u b

COLLECTION 2017





CONTENTS

CYLINDERS, ACCESSORIES AND VALVES	2
NEOPRENE SUITS 5/7MM	5
NEOPRENE SUITS AND SHORTIES 2/3MM	9
NEOPRENE BOOTIES AND ACCESSORIES	11
NEOPRENE GLOVES AND RASH GUARDS	13
BLADDERS AND HARNESSES	15
BCD JACKET STYLE	16
FINS	20
MASKS	24
CHILDREN EQUIPMENT	30
SNORKELS	32
REGULATORS AND ACCESSORIES	34
GAUGES/CONSOLES	39
TORCHES AND KNIVES	42
BUOYS AND ACCESSORIES	46
BAGS	51

**CYLINDERS,
ACCESSORIES
AND VALVES**

2



**NEOPRENE SUITS
5/7MM**

5



**NEOPRENE SUITS
AND SHORTIES
2/3MM**

9



**NEOPRENE
BOOTIES
AND ACCESSORIES**

11



**NEOPRENE
GLOVES
AND RASH GUARDS**

13



**BLADDERS
AND HARNESSES**

15



**BCD
JACKET STYLE**

16



20 FINS



MASKS

24



**CHILDREN
EQUIPMENT**

30



32

SNORKELS



**REGULATORS
AND ACCESSORIES**

34



**GAUGES /
CONSOLES**

39



**TORCHES
AND KNIVES**

42



46

**BUOYS
AND ACCESSORIES**



BAGS

51



TANKS

Code	Liquid capacity	Air capacity		Minutes under water	Working pressure		Outside diameter	Height	Weight	Material
	litres	cubic feet	litres	standard**	Bar	PSI	mm / inches	mm / inch	kg / lbs	
710211	10	70,6	2000	32,0	200	2900	171 / 6,7	575 / 22,6	10,2 / 22,4	CrMo
712212	12	84,8	2400	38,4	200	2900	171 / 6,7	670 / 26,4	12,1 / 26,8	CrMo
712202	12	84,8	2400	38,4	200	2900	203 / 8,0	505 / 19,9	13,6 / 29,9	CrMo
715202	15	105,9	3000	48,0	200	2900	203 / 8,0	610 / 24,0	16,2 / 35,6	CrMo
718202	18	127,1	3600	57,6	200	2900	203 / 8,0	715 / 28,1	18,7 / 41,1	CrMo
707312	7	57,4	1624	26,0	232	3360	140 / 5,5	590 / 23,2	9,3 / 20,5	CrMo
710235	10	81,9	2320	37,1	232	3360	171 / 6,7	590 / 23,2	12,3 / 27,0	CrMo
712235	12	98,3	2784	44,5	232	3360	171 / 6,7	690 / 27,2	14,2 / 32,0	CrMo
712237	12	98,3	2784	44,5	232	3360	203 / 8,0	505 / 19,9	15,9 / 35,0	CrMo
715233	15	122,9	3480	55,7	232	3360	203 / 8,0	620 / 24,4	18,4 / 40,5	CrMo
718204	18	147,5	4176	66,8	232	3360	203 / 8,0	740 / 29,4	21,1 / 46,4	CrMo
720010	20	163,9	4640	74,2	232	3360	203 / 8,0	800 / 31,5	22,6 / 49,7	CrMo
705213	5	40,2	1160	17,2	232	3360	140 / 5,5	450 / 17,6	6 / 13	CrMo
707314	7	74,2	2100	33,6	300	4350	140 / 5,5	590 / 23,2	10,3 / 22,7	CrMo
710311	10	105,9	3000	48,0	300	4350	171 / 6,7	600 / 23,6	15,7 / 34,5	CrMo
720057	5,8 (S40)	41,7	1179,9	18,9	207	3000	133 / 5,3	630 / 24,8	6,9 / 15,2	Al 6061
720111	11,1 (S80)	81,1	2297,7	36,8	207	3000	184 / 7,3	660 / 26,0	14,3 / 31,5	Al 6061
720043	4,3 (S30)	30	846	13,54	207	3000	133,3 / 5,3	510 / 20,2	6,1 / 13,4	Al 6061
720211	11,1 (S80) *	80	2256	36,10	207	3000	184,2 / 7,3	658 / 26,1	14,2 / 31,1	Al 6061
720260	0,9 (S6) *	6	169,2	2,71	207	3000	81,5 / 3,2	274 / 10,9	1,2 / 2,6	Al 6061
720261	1,9 (S13) *	13	366,6	5,87	207	3000	111,3 / 4,4	324 / 12,9	2,6 / 5,7	Al 6061
720227	2,7 (S19) *	19	535,8	8,57	207	3000	111,3 / 4,4	450 / 17,9	3,5 / 7,7	Al 6061
720243	4,3 (S30) *	30	846	13,54	207	3000	133,3 / 5,3	510 / 20,2	6,1 / 13,4	Al 6061
720258	5,8 (S40) *	40	1128	18,05	207	3000	133,4 / 5,3	640 / 25,4	7,4 / 16,2	Al 6061
720213	13,2 (C100) *	100	2820	45,12	228	3300	203,2 / 8,1	673 / 26,7	18,8 / 41,2	Al 6061
720267	8,2 (S63) *	63	1697	26	207	3000	184,2 / 7,25	551,2 / 21,7	12,02 / 26,6	Al 6061
720212	11,1 (C80) *	80	2530,8	41	228	3300	184,2 / 7,25	638 / 25,1	15,65 / 34,5	Al 6061

* available only with thread in 3/4 npsm

** standard is 62,5/minute, that is 25 breaths of 2,5litres each. Of course it depends on many factors such as the depth, the experience of the diver and others

Diving tanks made of chromium molybdenum steel and aluminium to 200, 232 and 300bars working pressure. Possibility to connect with compact valves featuring swivel DIN/INT ports both on main port and on second port. Steel tanks are available in 5, 7, 10, 12, 15, 18 and newly 20 litres!. Alu tanks are available in sizes from 0.9 ltr up to 13.2 ltr with working pressure of 207bar and 228bar. All tanks in CrMo come with a tank boot.



761200 203 mm / 8"
761201 171 mm / 6,7"

TANK CARRIER

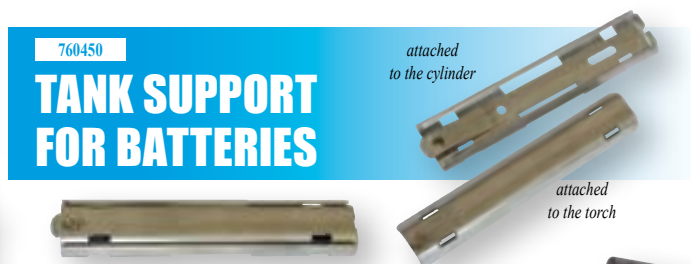

TANK SUPPORT FOR BATTERIES



760820

TANK STABILIZER

Avoids rolling over and potential damaging.



760800 standard
760810 swivelling

TANK CARRYING HOLDER



760300 171 mm / 6,7" 760320 140 mm / 5,5"
760310 203 mm / 8"

MONO TANK BOOT



Suitable for 7.25" (S80, S63, C80) 760340

TANK BOOT FOR ALU TANK

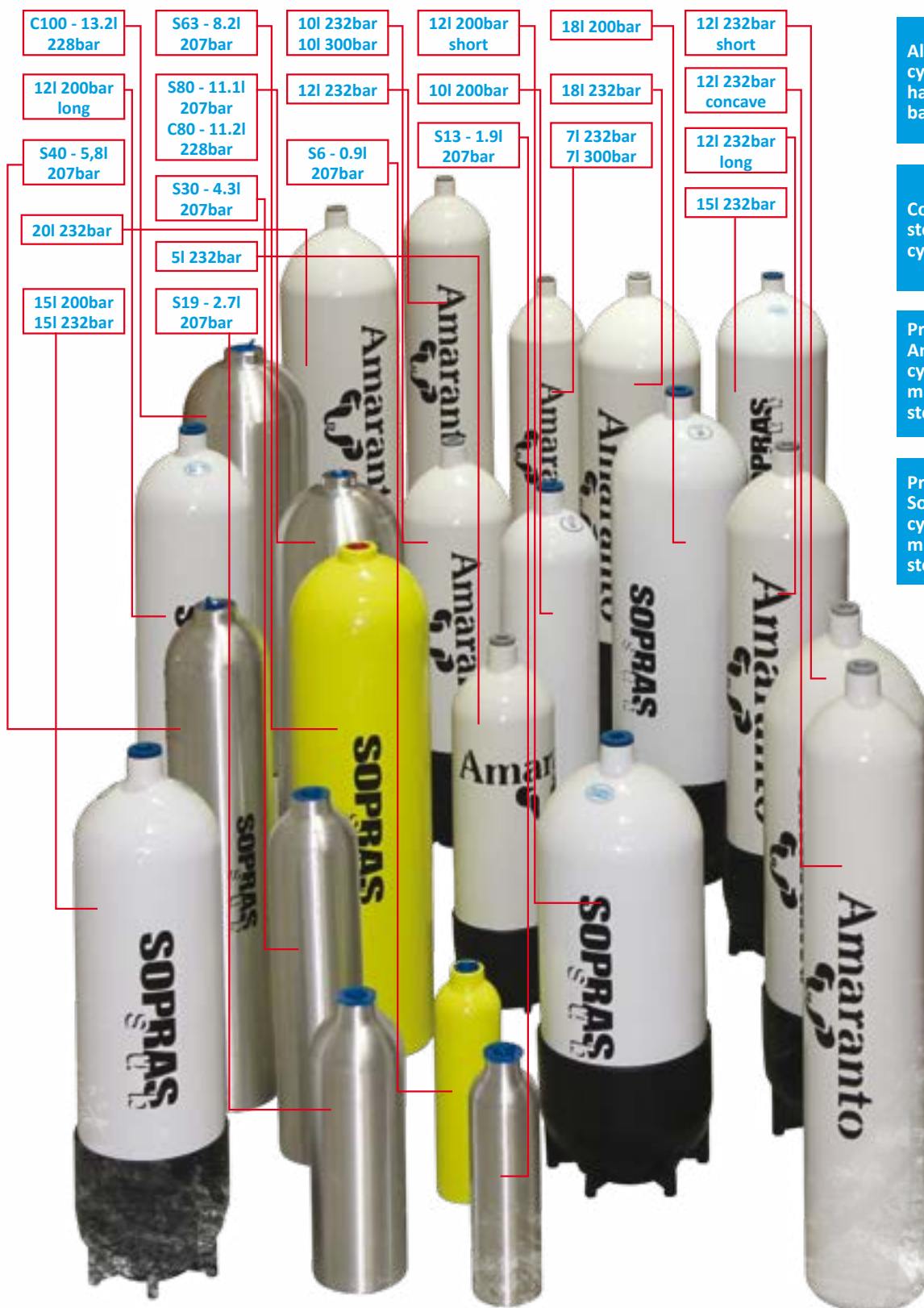

C100 - 13.2l
228bar

S63 - 8.2l
207bar

10l 232bar
10l 300bar

12l 200bar
short

18l 200bar

12l 232bar
short

12l 200bar
long

S80 - 11.1l
207bar
C80 - 11.2l
228bar

12l 232bar

10l 200bar

18l 232bar

12l 232bar
concave

S40 - 5.8l
207bar

S30 - 4.3l
207bar

S6 - 0.9l
207bar

S13 - 1.9l
207bar

7l 232bar
7l 300bar

12l 232bar
long

20l 232bar

5l 232bar

15l 232bar

15l 200bar
15l 232bar

S19 - 2.7l
207bar

Aluminium
cylinders
have a flat
base



Concave
steel
cylinder



Profile of an
Amarantosub
cylinder
made from
steel tube



Profile of a
Soprasub
cylinder
made from
steel plate



76060/K,Y For tanks with diam. 203mm
76061/K,Y For tanks with diam. 171mm

TANK MESH IN PVC

yellow or black



760500 colour

PROTECTING NET FOR TANK

available size for 7l, 10l, 12l, 15l, 18l



VALVES



730200	1 port	200 bar	M25x2	INT/DIN
--------	--------	---------	-------	---------

Z VALVE

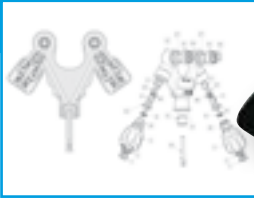

731200	2 ports	200 bar	M25x2	INT/DIN
--------	---------	---------	-------	---------

V VALVE

73232	1 port	232 bar / 3800 psi	3/4 npsm	INT/DIN
-------	--------	--------------------	----------	---------

Z VALVE (US MARKET)

Valve with thread 3/4NPSM and burst valve for US market.



73232	1 port	232 bar	M25x2	INT/DIN
-------	--------	---------	-------	---------

Z VALVE II.



734232	2 ports	232 bar	M25x2	INT/DIN
737300	2 ports	300 bar	M25x2	INT/DIN
735233	2 ports	232 bar	3/4npsm	INT/DIN

VALVE H



736300	1 port	300 bar	M25x2	DIN
--------	--------	---------	-------	-----

VALVE



732200	2 ports	200 bar	M25x2	INT/DIN
--------	---------	---------	-------	---------

ADJUSTABLE DOUBLE VALVE



740200	1 port	232 bar	17E small conical 19,80	INT/DIN
--------	--------	---------	-------------------------	---------

VALVE WITH CONICAL THREAD



739200	2 ports	200 bar	INT/DIN
--------	---------	---------	---------

G5/8 - regulator
M25x2 - tanks connection

DOUBLE VALVE FOR NITROX



738200	1 port	200 bar	INT/DIN
--------	--------	---------	---------

G5/8 - regulator
M25x2 - tanks connection

SINGLE VALVE FOR NITROX



738201	1 port	232 bar	DIN
--------	--------	---------	-----

M26x2 - regulator
M25x2 - tanks connection

MONOVALVE NITROX

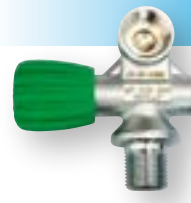
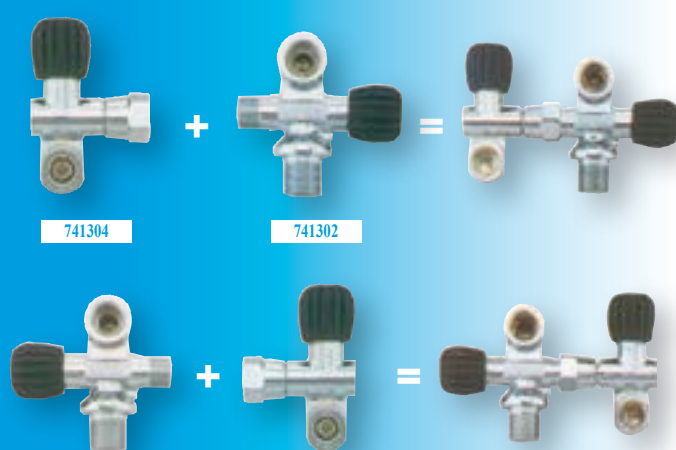
741304 + 741302 =

741300 + 741305 =

All valves can be for DIN and INT connections



103330 7 mm size: 2, 3, 4, 5, 6, 7, 8 thermoplush
nylon + supratex 1 piece colour

ISLANDA MAN



semi dry suit in 7 mm neoprene with warm plush on the inside and extremely stretch fabric for the outside; internal seals at wrists and ankles; very soft dry Tizip zipper on the back allows maximum mobility at the shoulder level; soft smoothskin seal at the neck and separated hood

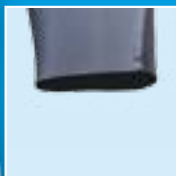

detail of the inside seal on both ankles and wrists

Tizip back zipper



separate hood

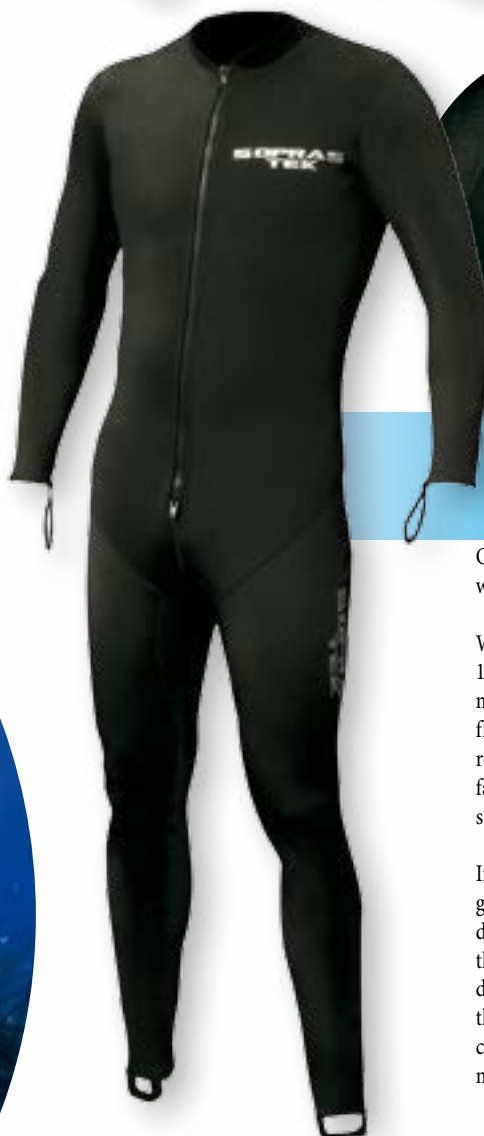

103331 7 mm size: 2, 3, 4, 5, 6 thermoplush
nylon + supratex 1 piece colour

ISLANDA LADY



113500 5 mm size: 2, 3, 4, 5, 6, 7, 8 thermoplush
nylon + supratex 1 piece colour

WHALE SKINSUIT

Our new Whale skinsuits have been especially designed for all water sports, in and outside of the water.

Whale CQQ (55% POLYESTER, 36% NYLON, 8% SPANDEX, 1% PU) is a completely new fabric developed with the aim to minimize thermal loss, thanks to a high quality super warm fleece for the inside layer, and keep you dry thanks to a water repellent outside lining. Thanks to these properties Whale fabric is just ideal for scuba diving, freediving, surfing, wind-surfing, sailing, kayaking...and everywhere it's wet or windy.

In scuba diving our Whale skinsuits can be used both as a garment under your dry or even neoprene suit as well as a standalone protective suit equivalent to a 5 mm neoprene suit with the advantage of being neutrally buoyant and extremely fast in drying thanks to the water repellent outer layer. Furthermore, thanks to its flexibility and elasticity our skinsuits will not at all constrain your movements and therefore will make your dive much more comfortable.



NEOPRENE SUITS 5/7MM

105200 7 mm size: 2, 3, 4, 5, 6, 7, 8 thermoplush

nylon + supratex 2 pieces colour

FREDDO EXTREME MAN EXTRASTRETCH



Freddo is a two-pieces suit composed by a jacket with front zipper, short sleeves, integrated hood and of a jumpsuit with back zipper; Very stretchy jersey lining on the outside with supratex reinforcement on the elbows and knees; internal seals and zippers at wrists and ankles; available in the standard version with 5mm or the version EXTREME in 7+7mm



back zipper
on the jumpsuit

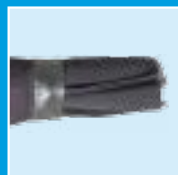

inside seal



zipper on wrists
and ankles

105300 7 mm size: 2, 3, 4, 5, 6 thermoplush

nylon + supratex 2 pieces colour

FREDDO EXTREME LADY EXTRASTRETCH



New knee pads in Supratex antiabrasion material of the highest quality.



zipper on wrists
and ankles



104100 5 mm size: 2, 3, 4, 5, 6, 7, 8 thermoplush

nylon + supratex 2 pieces colour

FREDDO MAN EXTRASTRETCH

104600 5 mm size: 2, 3, 4, 5, 6 thermoplush

nylon + supratex 2 pieces colour

FREDDO LADY EXTRASTRETCH



10280/2-8	5 mm	size: 2, 3, 4, 5, 6, 7, 8	thermoplush	nylon	1 piece	superstretch	colour	
103800/2-8	7 mm	size: 2, 3, 4, 5, 6, 7, 8	thermoplush	nylon	1 piece			

ANTIBES MAN

Fullsuit in 5 or 7mm extrastretch neoprene with blindstitching and warm plush inside, internal seals at ankles and wrists, anatomically preformed elbow and knee, kneepad and shoulder reinforcement in supratex lining, 10# YKK zipper.

Preformed knee and elbow in superstretch material

New knee pads in Supratex antiabrasion material of the highest quality.

Anatomically shaped for maximum comfort.



zipper on wrists and ankles



inside seal

10281/2-6	5 mm	size: 2, 3, 4, 5, 6	thermoplush	nylon	1 piece	superstretch
103900/2-7	7 mm	size: 2, 3, 4, 5, 6, 7	thermoplush	nylon	1 piece	
				colour		

ANTIBES LADY

Anatomically shaped for maximum comfort.



Preformed knee and elbow in superstretch material



NEOPRENE SUITS - 5 mm

10200/2-7	5 mm	size: 2, 3, 4, 5, 6, 7	thermoplush	nylon	1 piece
colour	■	AMALFI MAN			

10250/2-6	5 mm	size: 2, 3, 4, 5, 6	thermoplush	nylon	1 piece
colour	■	AMALFI LADY			



102550/3-8	5 mm	size: 2, 3, 4, 5, 6, 7, 8	extrastretch	nylon	1 piece
colour	■	CIPRO			

5mm superstretch neoprene jumpsuit with front zipper and separate hood for easy and universal wearing.

Supratex on the knee level

Abrasion resistant lining on the shoulder level

12400/3-7 3 mm size: 3, 4, 5, 6, 7 nylon + smoothskin 1 piece
colour ■

SHORTY PHANTOM MAN



12450/2-6 3 mm size: 2, 3, 4, 5, 6 nylon + smoothskin 1 piece
colour ■ ■

SHORTY ISIDA LADY



Shorty made of 3mm stretch neoprene suitable for tropical diving and other water sports. Abrasion resistant mesh skin on the chest.



am1030 3 mm size: 2, 3, 4, 5, 6, 7, 8
nylon + smoothskin 1 piece colour ■ ■

BAHAMAS EXTRASTRETCH MAN

am1031 3 mm size: 2, 3, 4, 5, 6
nylon + smoothskin 1 piece colour ■ ■

BAHAMAS EXTRASTRETCH LADY



Very stretchy 3mm neoprene with seals at ankles and wrists and supratex lining on elbows and knees. Back zipper



THE SIZES OF OUR SUITS

MAN							
sizes	2 / S	3 / M	4 / L	5 / L-XL	6 / XL	7 / XXL	8 / XXXL
Full height cm	165-170	170-175	175-179	179-183	182-186	186-189	188-193
Weight kgs	56-60	61-70	70-79	78-85	85-90	90-95	95-100
LADIES							
sizes	2 / S	3 / M	4 / L	5 / L-XL	6 / XL	7 / XXL	
Full height cm	155-163	163-170	170-175	175-179	179-183	182-186	
Weight kgs	49-52	52-56	56-69	69-78	78-85	85-90	

*please note the info in this table is only for rough reference

NEOPRENE SUITS - 2 / 3 mm

10270/3-7

3 mm

size: 3, 4, 5, 6, 7

nylon

nylon + smoothskin

1 piece

colour



VEGAS MAN

10273/2-6

3 mm

size: 2, 3, 4, 5, 6,

nylon

nylon

1 piece

colour



VEGAS LADY

3mm jumpsuit made of a very stretchy neoprene with back zipper and supratex lining on knee and elbow level.



10861/2-6

3 mm

size: 2, 3, 4, 5, 6

nylon

nylon + smoothskin

1 piece

ISIDA LADY

colour



108630

2 mm

colour



108640

2 mm

colour

size: 2, 3, 4, 5, 6, 7

nylon

10860/2-7

3 mm

colour



1 piece

nylon + smoothskin

ISIDA MAN

2 or 3 mm fullsuit with back zipper.
Also available in blue or yellow.



15100/5-12 3 mm size: 5 - 12 nylon colour ■

BOOTS WITH SOFT SOLE



15300/5-12 6 mm size: 5 - 12 nylon colour ■

BOOTS WITH HARD SOLE



In 6mm with thermoplush inside.



15800/5-13 5 mm size: 5 - 13 nylon colour ■

BOOTS WITH HARD SOLE



152100/5-13 5 mm size: 5 - 13 nylon colour ■

BOOTS 5MM HARD SOLE



16100/1-6 3 mm size: XS-XXL nylon colour ■

SOCKS IN DOUBLE LINED NEOPRENE



15710/5-13 5 mm size: 5 - 13 nylon colour ■

BOOTS IN 5MM DONUT SEAL

Dry boots (thanks to the donut seal).
No zipper and extrastretch material.



Comparison of sizes

US	Europe
5	36
6	37/38
7	39
8	40/41
9	42
10	43/44
11	45
12	46
13	47

NEOPRENE ACCESSORIES

156110

2,5 mm

size: 5 - 13

nylon

colour



LOW BOOTIES TROPICAL



15900/5-12

3 mm

size: 5 - 12

nylon

colour



ROCK BOOTS

With extra hard sole for rough surfaces. Sole with metal nails.



15610/1-7

3 mm

size: 6 - 12

nylon

colour



NEOPRENE AQUA SHOE



16210/1-4

5 mm

size: S, M, L, XL

nylon

thermoplush

colour



HOOD - 5mm LONG



16200/1-4

5 mm

size: S, M, L, XL

nylon

thermoplush

colour



HOOD 5MM EXTRA STRETCH

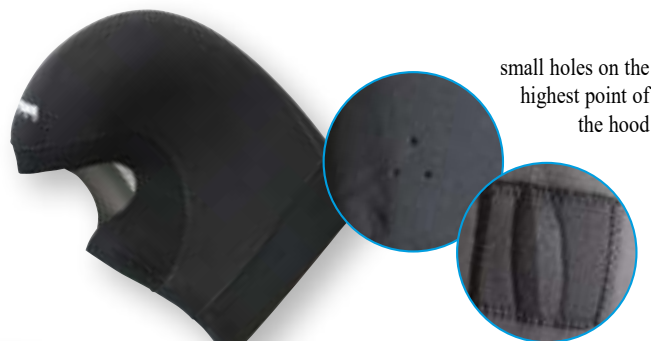

small holes on the highest point of the hood

CY1001-4

3 mm

size: S, M, L, XL

nylon

colour



CYCLING SOCKS



149640/XS-XL

5 mm

size: XS,S,M,L,XL

thermoplush

colour



KNEE PROTECTION

Kevlar lining, to be worn over your suit at the knee level, comes in pair



17400/1-4

3 mm

size: S, M, L, XL

nylon

colour



HOOD 3mm LIGHT



14200/0-4 5 mm size: XS, S, M, L, XL P. U. colour

GLOVES 5 MM PU

With anti slip grip and velcro closures. Available with PU or kevlar grip.



GLOVES 5 MM KEVLAR

14300/1-5 5 mm size: S, M, L, XL, XXL kevlar colour

NEOPRENE GLOVES

With anti slip grip and velcro closures.



14710/1-4 3 mm size: S, M, L, XL P.U. colour

GLOVES DONUT SEAL

with P.U. on palm



14400/0-4 2 mm size: XS, S, M, L, XL amara colour

GLOVES

With amara on palm. Velcro closures.



14600/1-4 5 mm size: S, M, L, XL P. U. colour

NEOPRENE GLOVES

With double seal, with anti slip grip.



14500/1-4 5 mm size: S, M, L, XL P. U. colour

GLOVES EXTENDED

With anti slip grip and velcro closures.



14800/1-5 3 mm size: S, M, L, XL, XXL supratex colour

NEOPRENE GLOVES

With supratex grip and velcro closures.



14100/1-6 3 mm size: XS, S, M, L, XL, XXL P. U. colour

NEOPRENE GLOVES

With anti slip grip.



NEOPRENE ACCESSORIES

13800/1-6 size: XS - XXL lycra lycra 1 piece
colour 

RASH GUARD LYCRA

Our rash guards offer great body protection and are ideal for using individually or underneath your suit. Thanks to its thermal and UV protection they are recommended for any other water sports.



13810/1-4 size: S - XL metalite lycra + neospan 1 piece
colour 

RASH GUARD - 0,5mm NEOSPAN AND METALITE INSIDE

Neoprene rash guard for higher heat retention, ideal for all water sports.



120000/S-XXL 3 mm size: S-XXL nylon colour 

UNDERVEST

Suitable under your diving suit.



162200 single torch
162201 double torch

NEOPRENE HOOD



14955/1-4 2 mm size: S, M, L

SWIMMING GLOVES



162202 for torches with up to 2,5 cm diameter
162203 for torches with up to 3,5 cm diameter
162204 for torches with up to 6,5 cm diameter

GOODMAN'S GLOVE

Goodman torch holder in 3 different sizes.



14720/0-4 2 mm size: XS, S, M, L, XL P.U. colour 

GLOVES SUPERSTRETCH

Very stretchy gloves with anti abrasion neoprene.



240102 standard strap
240112 hard strap

HARNESS DIR ON PLASTIC BACK PLATE

The cylinder strap is not included



MADE to MEASURE

If you wish to make changes, add D rings or any other kind of equipment we offer, you are more than welcome to let us know. We will follow your instructions and the harness will be "made to measure" for you.

240020

TEKNO DONUT 14L



Donut bladder with 14l or 16l buoyancy and one additional overpressure valve in the front low. Possible to combine with stainless steel, aluminium and plastic back plate

240030

TEKNO DONUT 16L



UTILITY POUCH SCROLLING

You can roll it and unroll it. Designed for attaching to 50 mm / 2" webbing.

230120 15 x 24 cm / 6 x 9,5"



230110 26 x 15 cm / 10 x 6"

UTILITY POUCH

Designed for attaching to 50 mm / 2" webbing with a large zipper pocket



901403 25 x 15 x 6 cm / 10 x 6 x 2,4"

THIGH STORAGE POUCH

Double straps around your thigh and hanging on your waist belt



901201

PLASTIC BACKPLATE

With 1 strap for tanks and adjustable shoulder straps.





20410/1-4

size: XS/S,M/L,XL/XXL

cordura 1000

cordura 1000

IWS

colour



SPELEO 1500 TEC WINGS

High volume single bladder made of Cordura 1000. Padded hard back pack. Cummerbund adjustable in 3 positions • 8 stainless steel AISI 316 rings for equipment fitting • Inflator with integrated valve • Overpressure / dump valves placed on shoulder and lower rear • Small zip-pocket in cummerbund. Two weight dump pockets of maximum 5kg / 22lb each. Lifting capacity: 22 kg / 48 lb.



Model	External material	Inner material	Padded Back plate	Size BUOYANCY (kg/lb)	Valves	Integrated weight system	Pockets	D Rings material
Silver 3000	Cordura 1000	Cordura 1000	YES	S/11,5/25 M/14,5/32 L/19,9/44 XL/19,9/44	3	2	2	8 stainless steel
Silver 4000	Cordura 1000	Cordura 1000	YES	S/11,5/25 M/14,5/32 L/19,9/44 XL/19,9/44	3	2	2	8 stainless steel
Speleo 1500	Cordura 1000	Cordura 1000	YES	S-M/22/48 M-L/22/48 L-XL/22/48	3	2	2	8 stainless steel
PX 500	Nylon 420	Nylon 420	YES	S/11,5/25 M/14,5/32 L/19,9/44 XL/19,9/44	3		2	4 plastic
Dive Center	Nylon 420	Nylon 420	YES	S/11,5/25 M/14,5/32 L/19,9/44 XL/19,9/44	3		2	4 plastic
Dive Center BCD deluxe	Nylon 420	Nylon 420	YES	S/11,5/25 M/14,5/32 L/19,9/44 XL/19,9/44	3		2	4 aluminium
Explorer	Nylon 420	Nylon 420	YES	XS/10/22 S/10/22	3		2	4 plastic

900340

for 171 mm tanks

900341

for 203mm tanks

BELT FOR TANKS WITH STAINLESS STEEL QUICK RELEASE CAM BUCKLE



900330

STAINLESS STEEL QUICK RELEASE CAM BUCKLE



805800

AIR ACOUSTIC SIGNAL (135dB)



on the inflator hose

901409

CYLINDER STRAPS WEIGHT POCKETS

each buckle pocket 4kg (8kgs in total)

20510/1-4 size: S/11,5 kg / 25 lb; M / 14,5 kg / 25 lb; L, XL / 19,9 kg / 25 lb

cordura 1000

colour



SILVER 3000



Silver 3000 is totally made of Cordura 1000 and is equipped with dump weight pockets for 4 kgs (size S) or 5kgs (M to XL) - 9/11lb each. Weight pockets are also positioned at the back of the BCD. Two cylinders straps guarantee maximum safety. Huge pockets on the sides and small zipper pocket on the waist strap.



901402

DUMP POCKET

for Silver 3000



20520/1-4

size: S/11,5 kg / 25 lb; M / 14,5 kg / 25 lb; L, XL / 19,9 kg / 25 lb

cordura 1000

colour



SILVER 4000

Silver 4000 is made entirely of Cordura 1000 and is equipped with comfortable dump weight pockets for 4 kg each to be released after opening a buckle. Side pockets are spacious and easy to reach with a slot for positioning an octopus regulator. Small zipper pocket on the waistband.



20240/1-4

nylon 420

size: S / 11,5 kg / 25 lb, M / 14,5 kg / 32 lb, L, XL / 19,9 kg / 44 lb

PX 500

colour 



Basic jacket style BCD with bladders from 15 up to 20litres of volume in Nylon 420 fabric. Two large pockets on the sides, adjustable cummerband, handy slot for positioning an octopus regulator.



size M

20000/0-4

nylon 420

colour 

size: S/11,5 kg / 25 lb; M / 14,5 kg / 25 lb; L, XL / 19,9 kg / 25 lb

DIVE CENTER

20001/0-4

nylon 420

colour 

size: S/11,5 kg / 25 lb; M / 14,5 kg / 25 lb; L, XL / 19,9 kg / 25 lb

DIVE CENTER DELUXE

BCD especially designed for dive centers with very spacious pockets in very well visible yellow colour with a slot for positioning your octopus regulator. The single bladder is available from with 15 up to 20litres of volume and is in Nylon 420 fabric. The size of the BCD is easily recognizable being positioned on the left shoulder. The standard version is with plastic rings but the deluxe version is available as well with black aluminium rings!



SPARE PARTS FOR JACKETS

901200 BACK PLATE



901100 O.P. VALVE

Over pressure valve.

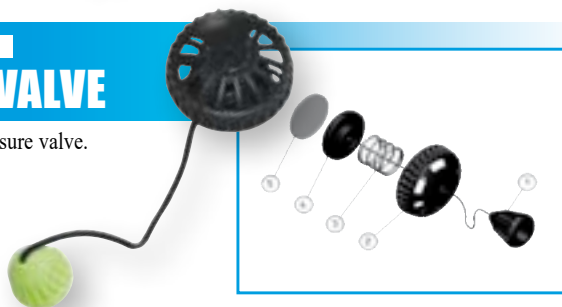

901010 INFLATOR 340

For jacket PX 420, PX 500, EXPLORER, DIVE CENTER.



901000 INFLATOR 460

For Speleo jackets, Silver jackets, Tech 1000, Amazon.



900310	110 cm (with friction pad)
900311	135 cm (no friction pad)

BELT FOR TANKS

900300 50 mm - plastic CAM BUCKLE



901010/1-32 PARTS FOR 340

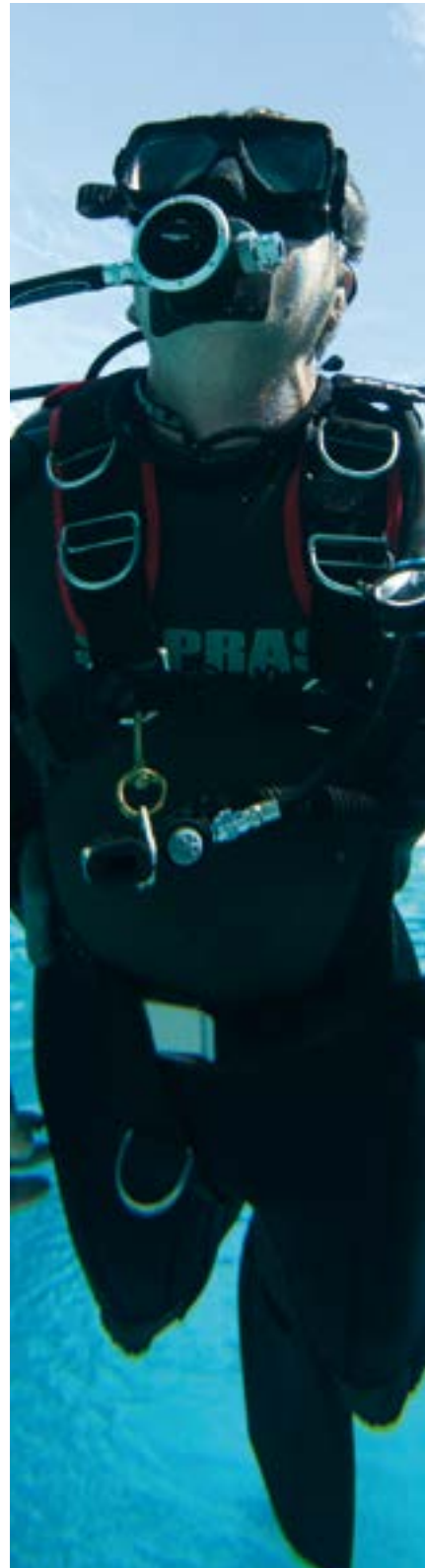
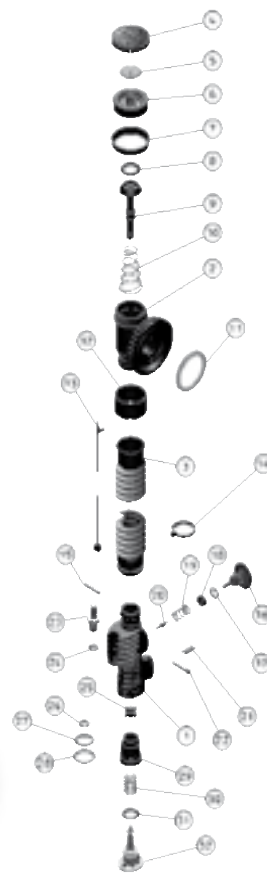

901000/1-33 PARTS FOR 460

FINS

4160-SR/LR size: S/M, L/XL strap fin thermoplastic rubber
colour

NEMO

4300S/M/L/XL-B/G/Y size: S, M, L, XL strap fin thermoplastic rubber
colour

NAUTILUS

Nautilus and Nemo are professional multi-purpose fins, with quick adjusting, quick release buckles. The anatomic soft foot pocket is made of thermoplastic and rubber with different thickness of sole, suitable for use with neoprene socks or boots. Laterally reinforced blade by large directional ribs to remove all obstacles to the free flow of water. The blade is longer than usual to improve the thrust forward. The central part is made of rubber to improve the transmission of power with less effort during the thrust.



4290S/M/L-B/K/W S/M, M/L, L/XL strap fin thermoplastic rubber
L/XL = 3,5 kg (7lbs)/pair M/L = 2,7 kg (5,5lbs)/pair
S/M = 2,3 kg (5lbs)/pair colour

ATOMICA

Atomica fins features an advanced multi-flex blade, made from 3 different materials reducing diver fatigue and air consumption but still giving the diver a fast and powerful propulsion even stronger than a traditional blade fin.

The side rib (harder material), efficiently converts the energy of a kick into propelling power. The blade (medium material), increases the efficiency of the water channel. The foot pocket (very soft material), enhances the fitting comfort and transferring of the power to the ribs and blade. The excellent fit and non-wasteful transmission of energy ensures that body fatigue and air consumption is minimized.



colour 4250S-M-L/Y-B-K size: S/M, M/L, L/XL strap fin thermoplastic rubber

EXCEED

441000

size: S/M, M/L, L/XL

strap fin

thermoplastic

rubber

POWER

colour



41608S/M/L/XL

size: S, M, L, XL

stainless steel

S.S. SPRING STRAP

For fins with plastic buckle.



41605S,M,L

size: S, M, L

silicone

SILICONE STRAP

With male buckle in 3 sizes. Very handy and easy to wear on booties.



902000

rubber

REPLACEMENT STRAP FOR FINS

POWER, RETTA and GRILLO are professional multi-purpose fin, with quick-adjusting and quick-release buckles and anatomic soft foot pocket made of thermoplastic and rubber with different thickness of sole, suitable for use with neoprene socks or boots. The combination of rubber and thermoplastic gives to these fins the perfect combination of power and comfort.

40800/1-2

size: L/XL, XL/XXL

strap fin

thermoplastic

rubber

RETTA

colour



40251-3K/S/Y

size: M/L, L/XL

strap fin

thermoplastic

rubber

GRILLO II

colour



40600/1-2

size: S/M, M/L

strap fin

thermoplastic

colour

**MITO**

Very robust ideal for daily use in dive centers.



FINS

42301-2/Y-B	size: 32/34, 34/36	full foot	thermoplastic	rubber
42303-4/Y-B	size: 37/38, 38/39	full foot	thermoplastic	rubber
42305-7/Y-B	size: 40/42 - 45/46	full foot	thermoplastic	rubber
		colour	<div> <div></div> <div></div> <div></div> </div>	

VELOCE II



Closed heel fin made of thermoplastic and rubber. Suitable for snorkelling and diving with bare feet.

4260/01-08	sizes: 38/40, 40/42, 42/44, 44/46	full foot	thermoplastic	rubber
		colour	<div> <div></div> <div></div> <div></div> </div>	

GRILLO



Snorkelling fins in thermoplastic and rubber.

410038-44	size: 38/39 to 44/45	full foot	thermoplastic	rubber
		colour	<div> <div></div> <div></div> <div></div> </div>	

SPIDER



These fins are unique in its design and material used (thermoplast and rubber) and are made for snorkelling and freediving. The product boasts excellent dynamics with main benefit being that the blade remains under the water surface at all times when snorkelling. Besides, thanks to different positioning of legs and blades virtually no whirling effect is created - that eliminates negative flow and water resistance when moving legs. Also, the new fins allow trouble-free walking on land.

415036-46	size 36/37 to 46/47	full foot	thermoplastic	rubber
		colour	<div> <div></div> <div></div> <div></div> </div>	

FLEXA



Very robust ideal for daily use in dive centers.



42700/0-2

size: 32/37, 38/41

strap fin

thermoplastic

rubber

colour



SHIC

Ideal for ladies caring for their looks in all situations. Combination of thermoplastic and rubber these fins maximize the thrust with minimum effort.



851300

68 x 28 cm / 27 x 11"

nylon 420 denier

SNORKELLING BAG



Material: 420 denier Nylon with PVC coating. Main pocket holds up to size XL fins. Outer pocket holds both mask and snorkel. With shoulder carrying strap.



851110

55 x 23 cm / 21,5 x 9"

FINS BAG



442000

size S/M, L/XL

strap fin

thermoplastic

rubber

colour



JUMP

Snorkelling fins in thermoplastic and rubber with strap pocket to be used with both socks or on bare feet.



MASKS

302701

2 - glasses

silicone

colour



COMODA

Foldable mask with no hard frame.

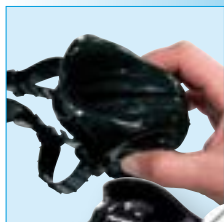

33201B/P

2 - glasses

silicone

transparent

colour



LEGGERA



33201B



33201P

31700K

1 - glass

silicone

colour



TALARIA



30360/0,B,K,W

1 - glass

silicone

transparent

colour



OCCHIO



30360K



30360W

334000

2 - glasses

silicone

black

colour



MAGICA



30360B

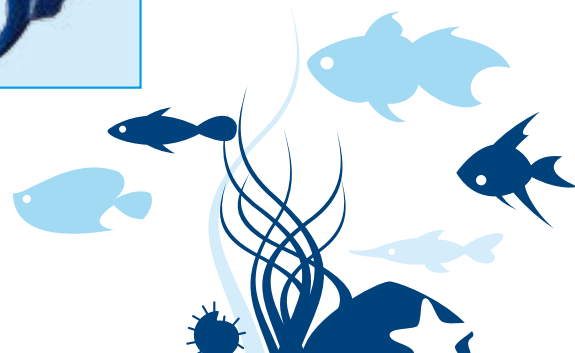

31850B

2 - glasses

silicone

colour



ALTA



31851B

2 - glasses

silicone

transparent

colour



ALTA CLEAR



302400

2 - glasses

silicone

black

colour



GOPRO MASK



33000B, R

2 - glasses

silicone

transparent

colour



LUCIDA



33000R



30350R



30350K

30350B, K, R, Y

2 - glasses

silicone

colour



SUPERBA



30350B



30351B



30351P

FRAMELESS MASKS

33300K 1-glass silicone black colour ■

FORTE



33300W 1-glass silicone transparent colour ■

FORTE



33500K 1-glass silicone black colour ■

FUTURA



33500C 1-glass silicone transparent colour ■

FUTURA



306301 2 - glasses silicone colour ■

FRAMELESS II



306300



305100

1 - glass

silicone

colour



FRAMELESS



305000

306100

1 - glass

silicone

colour



FRAMELESS STAR II



325001

2 - glasses

silicone

colour



PERFETTA



325010

2 - glasses

silicone

colour



PERFETTA II



325011

302601

1 - glass

silicone

colour



EXCEL

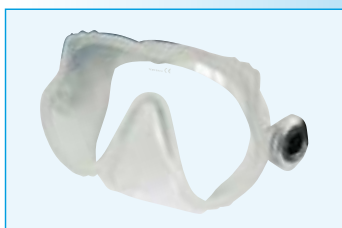

302600



30260B



MASKS

30100/B, K

4 - glasses

silicone

transparent

colour



VISUAL



30100K

30341P

2 - glasses

silicone

transparent

colour



CURIOSA



30340B



30340R

3400/15-75

OPTICAL LENSES

For Visual mask from - 1,5 - 7,5, every 0,5



981480

1 - glass

silicone

transparent

colour



VEDO

swimming goggles with
an amazing view



902100

silicone

transparent

colour



902200

silicone

black

colour



REPLACEMENT STRAP FOR MASKS



851100

MASK POUCH DELUXE



323000

MASK POUCH



323001

MASK BOX



163000

3 mm

nylon

colour



NEOPRENE MASK STRAP



16301K/C

3 mm

nylon

colour



MASK STRAP



163020

3 mm

nylon

colour



NEOPRENE MASK STRAP



with bungee



322400

2 - glasses

silicone

transparent

colour



PRO EAR MASK

Designed to meet the needs of those having problems equalizing or having ear infections.

The equalization tubes have a valve that allows air flowing into the ear covers but no water or air in the opposite direction

The strap is mounted on swivel buckles securing adherence of the covers to the ears

The ear covers, creating a water tight seal between the ear drum and the cover, ensures the pressure is the same as in your mask. The over pressure in the mask is conducted via the tubes to the covers and therefore the "squeeze" from outside is much less. Moreover it protects the ear from potential infections and gives a sense of warmth to the diver



32231/B,R

1-glass

silicone

transparent

colour



FULL FACE SNORKEL MASK

The first full face snorkelling mask designed to make snorkelling effortless and natural. It will let you breathe normally under water just the same as you would on land.

No more breathing through your mouth or checking if your snorkel is in the right position. The mask is extremely easy to use and after experiencing the comfort, and natural breathing ability under water you will never go back to your old snorkel and mask...

Thanks to its large size, this innovative mask also offers an unobstructed 180° field of vision, and fogging up is prevented by a double air-flow system. To ensure water does not enter via the snorkel, the mask is equipped with a mechanism that plugs the top of the snorkel when immersed in water. Furthermore the top of the snorkel is highly visible on the surface.

This mask is great for anyone who likes to take pictures while snorkelling, the wide field of view makes it super easy to have a clear view of your environment.

The mask comes with a handy backpack.



801000

30 ml

ANTIFOG FOR MASKS



CHILDREN EQUIPMENT

20100/1-2

size: S - 10 kg / 22 lb / XS - 10 kg / 22 lb

Nylon 420

colour



EXPLORER

Junior BC with bladder in nylon 420.
Padded hard back pack • Inflator with integrated valve • Over-pressure / dump valves placed lower rear • Belt with Velcro-closure
• Two large Velcro-closure pockets



11205/S-XL

3 mm

size: S, M, L, XL

full suit for children

nylon / nylon

1 piece

colour



DISCOVER

3mm stretch neoprene with double lining and back zipper suitable for children from 7 to 14 years old



11100/1-4

3 mm

size: S, M, L, XL

nylon

nylon

1 piece

colour



CHILDREN SHORTY

Back zipper. Suitable for children from 7 to 14 years old.



1110/21-9

2 mm

size: 21 - 29

nylon

nylon

1 piece

colour



KIDS SHORTY

In 2mm with back zipper.
Sizes from 21 to 29 (from 3 to 7 years of age).



475010

transparent

silicone

colour



YOUNG DIVER SNORKELLING SET

Silicone snorkel and mask.



46100/B, K

valve

silicone

colour



BABY SNORKEL WITH VALVE



473000

valve

silicone

colour



DISCOVER SNORKEL



31702B

1 - glass

transparent

silicone

colour



TALARIA SMALL



40201B

size: 27/31

strap fin

thermoplastic and rubber

colour



40202B

size: 32/37

strap fin

thermoplastic and rubber

colour



EXPLORA FINS



427002

size: 32/37

colour



SHIC (32-37) PINK



Ideal for small ladies caring for their looks in all situations. Combination of thermoplastic and rubber these fins maximize the thrust with minimum effort.



851310

size: 55x23cm

colour



CHILDREN SNORKELLING BAG

5 colours are available!

SNORKELS

46600/B, K valve silicone no drops system

colour 

CICLONE

Black silicone.

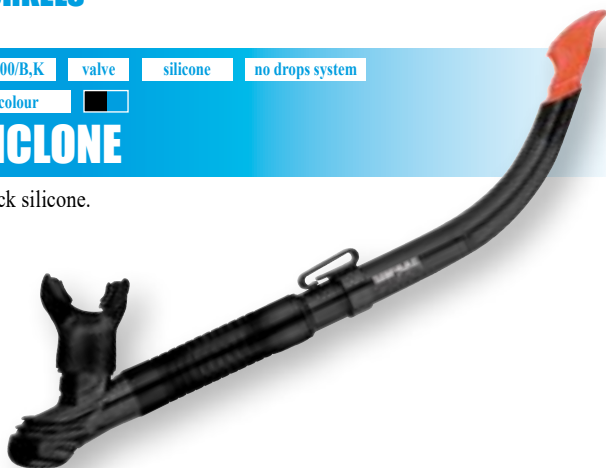

46610/B, K valve silicone no drops system

colour 

CICLONE CLEAR

With transparent silicone.



46900/B, K valve silicone no drops system

colour 

MORBIDO CLEAR

With transparent silicone.



46910/K, R valve silicone no drops system

colour 

MORBIDO



46500P valve silicone dry

colour 

SHIC DRY SNORKEL

Ideal for ladies caring for their looks in all situations.



46500K valve silicone dry

colour 

SHIC DRY SNORKEL



46750R, B valve silicone no drops system

colour 

TORNADO

Black silicone.



47100/K, B double valve silicone no drops system

colour 

GOLF

Snorkel double valve



47200W valve silicone

colour 

HYDRA



46800/B, K valve silicone dry
colour 

LUMINOSO DRY SNORKEL

With integrated whistle

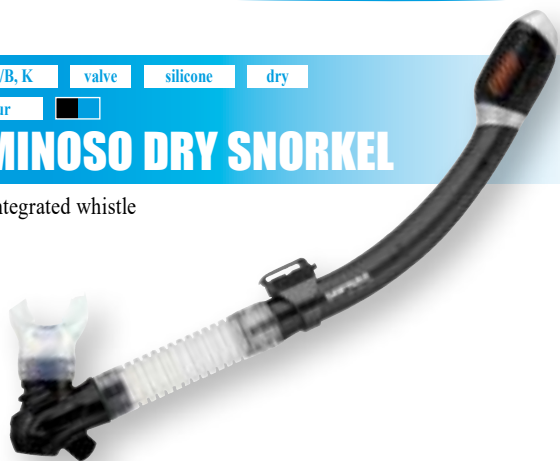

45200/B, E, Y, S valve silicone no drops system
colour 

PEGASO



45900/B, K, Y valve silicone no drops system
colour 

EGO



45300/B, K, Y valve silicone
colour 

VESUVIO



45710/B, K, Y valve silicone
colour 

ETNA II



45000/B, K, Y silicone
colour 

SORI



467000 valve silicone no drops system
colour 

COMODO



100% silicone, this snorkel can be folded and placed in your pocket.

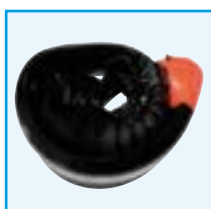

SWIVEL SNORKEL KEEPER

477100 colour 



SNORKEL KEEPER

477000 colour 

With quick release.



REGULATORS

60221/0-1 2 HP 4 LP INT/DIN membrane

1. STAGE JUPITER NEW



Very compact balanced diaphragm first stage. Simple, strong, reliable. Excellent performance with extremely low weight and dimensions.

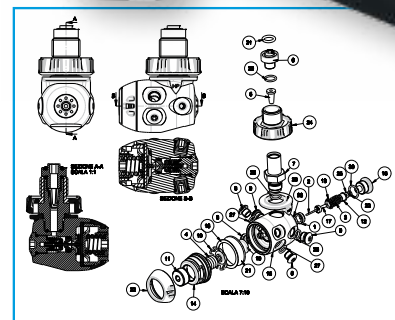
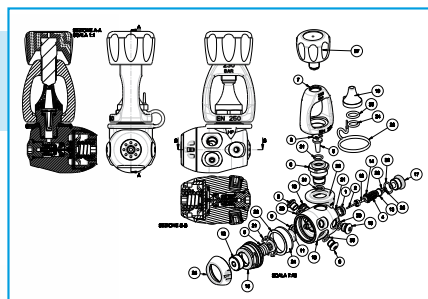

Also available in the antifreeze version

631005

2. STAGE VENUS NEW

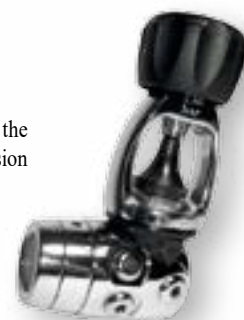

601220/1 1 HP 4 LP INT/DIN piston

1. STAGE GENIUS NEW

Piston first stage, robust and simple to maintain.

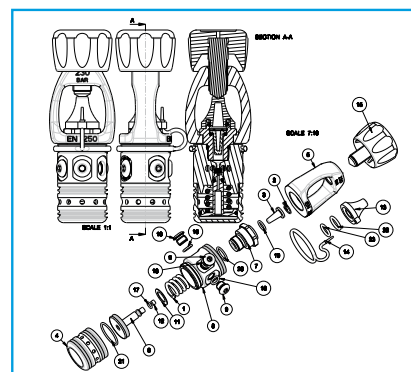
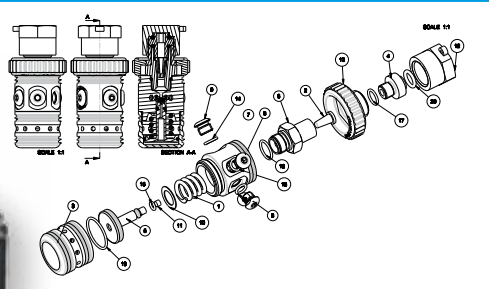

602310	Genius New/Venus New DIN
602311	Genius New/Venus New INT
602312	Jupiter New/Venus New DIN
602313	Jupiter New/Venus New INT

ALL COMBINATIONS OF STAGES ABOVE ARE CE CERTIFIED



620030

OCTOPUS IV

Including yellow hose of 90 cm / 35".



620021

OCTOPUS II

Including yellow hose 90 cm / 35".



652000

MIDDLE PRESSURE GAUGE STRAIGHT SCREWING

Easy adjustment of second stage. Pressure - 10 bar / 170PSI. With straight or esagonal screwing.



652001

MIDDLE PRESSURE GAUGE ESAGONAL SCREWING



852010

35 x 20 cm / 14 x 8"

REGULATOR BAG DELUXE



852000

40 x 25 x 10 cm / 16 x 10 x 4"

REGULATOR BAG



ACCESSORIES FOR REGULATORS

AM3920

EXTRA AIR SOURCE

Extra Air Source 1st Stage, 3/4" - 14 thread,
Tank valve with integrated 1st stage



am3922 - YOKE QD filler



am3921 - Station QD filler

806002

ADAPTER

Adapter male 9/16 to female BC standard.

806102

110° CONNECTION

For 2nd stage



806100

360° REGULATOR SWIVEL



806110

SWIVEL ATTACHMENT TO 2nd STAGE



806001

ADAPTER

Male 9/16 to Female 3/8-24



806003

ADAPTER

Adapter single male 9/16-18 to double female 3/8-24



806104

360 SWIVEL FOR HP HOSE



806103

360° 1ST STAGE LP PORT ADAPTER



806101

90° CONNECTION

For 2nd stage



654000

ADAPTER INT/DIN



654010

ADAPTER DIN/INT



654020

JUPITER / NEPTUN

300 bars / 4350 PSI

300 BARS CONNECTION

1st stage



654030

GENIUS / ZENITH

300 bars / 4350 PSI

300 BARS CONNECTION

1st stage



O RINGS

39 various sizes. More info upon request.



900402: 15 cm / 6"

900403: 20 cm / 8"

900404: 60 cm / 23,5"

900400: 80 cm / 31,5"

HP HOSE

900499: 60cm / 25"

900500: 74 cm / 29"

900510: 80 cm / 31,5"

900520: 90 cm / 35,5"

BC HOSE

900409: 55 cm / 22"

900410: 72 cm / 28"

900411: 92 cm / 37"

900412: 100 cm / 40"

900413: 210 cm / 84"

900450: 150 cm / 60"

REGULATOR HOSE

900419: 72 cm / 28"

900420: 92 cm / 36"

900430: 100 cm / 39"

900432: 150 cm / 59"

900434: 200 cm / 79"

OCTOPUS HOSE

900529: 60 cm / 25"

900530: 70 cm / 28"

colour



900527: 60 cm / 25"

colour



900528: 60 cm / 25"

colour



90053W: 70 cm / 28"

colour



BC HOSE BRAIDED

900540: 90 cm / 36"

900541: 70 cm / 28"

colour



900542: 150 cm / 60"

900547: 100 cm / 25"

colour



900548: 70 cm / 28"

900543: 210 cm / 82"

colour



900549: 70 cm / 28"

colour



REGULATOR HOSE BRAIDED

900545: 95 cm / 38"

900544: 80 cm / 32"

OCTOPUS BRAIDED HOSE

900406: 70 cm / 28"

HP HOSE BRAIDED

900560: 70 cm / 28"

EXTRA SOFT REGULATOR HOSE

806200

SMALL ALU TANK FOR O/RINGS



909000

HP SWIVEL



801320

MAGNETIC OCTOPUS HOLDER



760720

SET OF TOOLS FOR O-RINGS

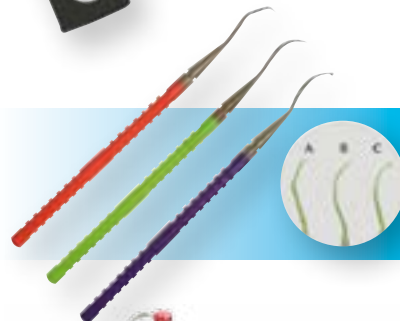

AM0920

OCTOPUS HOLDER



900560: 70 cm / 28"

900561: 80 cm / 32"

EXTRA SOFT REGULATOR HOSE



900570: yellow - 80 cm / 32"

900571: green - 80 cm / 32"

EXTRA STRONG OCTOPUS HOSE



ACCESSORIES

806670 silicone transparent

CHILDREN MOUTHPIECE



806690 silicone transparent

SILICONE MOUTHPIECE



806610 silicone colour ■

SILICONE MOUTHPIECE



806620 silicone transparent

SILICONE MOUTHPIECE LONG



806630 silicone colour ■

SILICONE MOUTHPIECE LONG



80666/G, R, B, Y silicone colour ■ ■ ■ ■

COMFORT DUAL SILICONE MOUTHPIECE



653000

TOOLS FOR REGULATOR MAINTENANCE



904000

SPANNER WRENCH



806400 rounded

806500 anatomic

SILICONE MOUTHPIECE COVER



761100 colour ■

AIR PISTOL



761000 colour ■

VALVE CAP



806651 colour ■

MOULDBLE MOUTHPIECE



The mouthpiece must be bit after being in hot water for a couple of minutes and it will take the shape of your teeth.



MOULDBLE MOUTHPIECE

806650 transparent



900550

BC HOSES QUICK RELEASE



PRESSURE GAUGES

Shock resistant pressure gauges, complying with the CE directive, designed to absorb violent shocks. Nickered brass case and bourdon spiral spring 414 BAR resistant (6.000 P.S.I.). Luminous dial. Accuracy + or - 1,5%. Kevlar and rubber H.P. HOSE 80cm long in conformity with DEMA 105 (USA) specification. 7/16" Fittings. Working pressure 276 BAR (4.000 P.S.I.); test pressure 345 BAR (5.000 P.S.I.); bursting pressure higher than 1.300 BAR (18.850 P.S.I.). Safety coefficient 5:1. All manometers are available in PSI and in BARS and all depth meters are available in meters as well as in feet.



501200	400 bar	diam. 45 mm / 1,8"
501201	5000PSI	diam. 45 mm / 1,8"

MINI

Small pressure gauge in bar or PSI.



501400	300 bar	diam. 60 mm / 2,4"
501401	5000PSI	diam. 60 mm / 2,4"

STANDARD

Pressure gauge in bar or PSI.



501300	300 bar	diam. 52 mm / 2,1"
501301	5000PSI	diam. 52 mm / 2,1"

TEK

With tempered glass in bar or PSI.



501410	300 bar	diam. 60 mm / 2,4"
501411	5000PSI	diam. 60 mm / 2,4"

STANDARD THERMO

Pressure gauge with thermometer in bar or PSI.

502100	400 bar	diam. 45 mm / 1,8"
502101	5000PSI	diam. 45 mm / 1,8"

MINI OXYGEN/NITROX

Small pressure gauge for NITROX in bar or PSI.



501050	350 bar / 5000 psi
--------	--------------------

PONY BOTTLE GAUGE



Dial for depth gauge in feet.

DEPTH GAUGES

Professional depth gauges, with beryl membrane. Available in simple or double scale luminescent dials for better reading during dive or decompression. Accuracy + or - 1.5% - maximum depth indicator. Some of the models have the zero adjustment to compensate temperature and ambient pressure.



513100	70 m	diam. 55 mm / 2,2"
513101	200 feet	diam. 55 mm / 2,2"

MINI

Small depth gauge in meters or feet.



513000	80 m	diam. 65 mm / 2,6"
513001	230 feet	diam. 65 mm / 2,6"

STANDARD

Depth gauge in meters or feet.

CONSOLES



531200	400 bar
531201	5000 PSI

**COMBO 2
COMPASS MINI**

Small pressure gauge
in bar or PSI and compass.



531300	400 bar	70 m
531301	5000 PSI	200 feet

**COMBO 2
MINI**

Small pressure gauge in bar or PSI
and depth gauge in meters or feet.



535100	400 bar	70 m
535101	5000 PSI	200 feet

COMBO 3 MINI

Small pressure gauge in bar or
PSI, compass at the back and
depth gauge in meters or feet.



531400	300 bar	80 m
531401	5000 PSI	230 feet

COMBO 2

Pressure gauge in bar or PSI,
and depth gauge in meters or feet.



531410	300 bar	80 m
531411	5000 PSI	230 feet

COMBO 2 THERMO

Pressure gauge in bar or PSI, thermometer
and depth gauge in meters or feet.



535200	300 bar	80 m
535201	5000 PSI	230 feet

COMBO 3

Pressure gauge in bar or PSI,
compass at the back and
depth gauge in meters or feet.



535300	300 bar
535301	5000 PSI

**COMBO 2
COMPASS**

Pressure gauge in bar or PSI and compass.



535210	300 bar	80 m
535211	5000 PSI	230 feet

COMBO 3 THERMO

Pressure gauge in bar or PSI, compass at the back,
thermometer and depth gauge in meters or feet.

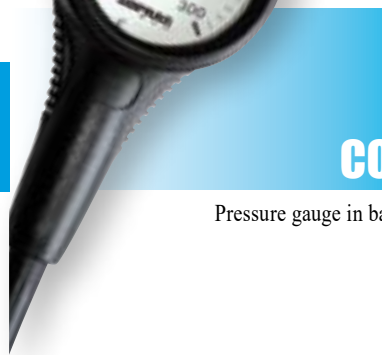

535310	300 bar
535311	5000 PSI

**COMBO 2
COMPASS THERMO**

Pressure gauge in bar or PSI, thermometer and compass.



531100	300 bar	80 m
531101	5000 PSI	230 feet

COMBO 2 TEK

Pressure gauge TEK in bar or PSI and depth gauge in meters or feet.

COMPASSES - WATCHES

522300

COMPASS WITH HOLSTER

To be added to Combo 2 Tek.



522100 diam. 65 mm / 2,6"

STANDARD COMPASS

Standard wrist compass.



522200 diam. 55 mm / 2,2"

COMPASS MINI

Small wrist compass.



807000

DIVING WATCH

Stainless steel case.
Japanese movement.
200 m / 650 ft waterproof.

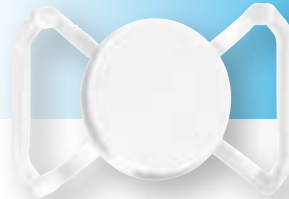

807010

WATCH PROTECTOR

With lens.



56000/0 = DIN 1000 mm / 39"
56000/1 = INT 1000 mm / 39"

TANK PRESSURE EQUALIZER



563000 = DIN 563001 = INT

TANK PRESSURE EQUALIZER WITH PRESSURE GAUGE



562000 = DIN 562001 = INT

TANK TESTER

DIVING TORCHES

806982 210 x 42 mm 900 lumens

EK 900



Material: Aluminium Alloy / Surface: Anodized
Switch Mode: Twist On Type
The torch is opened from the back turning the end cap. The rubber ring around the torch head protects the head from damaging.
Bulb Type: CREE single-chip
LEDBrightness: 700 or 900 lumens
Beam Angle: 10° / Battery: 3 x C Alkaline Battery
Run Time: appr. 3 hours (EK 900) and 4 hours for EK 700
Depth Rating: 100m/300ft / Size: 210 x 42mm

806980 210 x 42 mm 700 lumens

EK 700



805910

STROBE FLASH LIGHT

Strobe flash light with torch.



806948

CABLE

Cable for connecting to external power supply, makes the torch usable as speleo lamp. Suitable for Alu Lite 6.



806965 with CR123 battery 20 x 160 mm / 0,8 x 6,3"

806985 with 2AA batteries 20 x 160 mm / 0,8 x 6,3"

SIGNALLING STICK

Handy signalling unit with brilliant colour options for night dives, especially on surface. Burn time: 2 hours. Fine thread and twin o-rings makes the Signal Stick waterproof to 100 m. Lanyard included.



806979 128 x 44 mm 160 lumens

EK 160

LED backup torch push-button style
Battery: 3 x AAA
Surface: aluminium
Anodized
Colour: titanium
Burn Time: 8 HRS
Turn on and off with the back button.



806971 15 x 120 mm / 0,6 x 4,7" CONSTANT

806972 15 x 120 mm / 0,6 x 4,7" FLASHING

SMALL SIGNALLING STICK



1x Superbright LED
Battery: 3x LR44
Autonomy: 50 hours
Depth test: 100m

806920

CHEMICAL LIGHT STICKER



806947 diam. 35 mm / 1,38"

LAMP HOLDER GOODMAN



801200

WRIST MOUNTED LAMP HOLDER





High quality and professional design. 420 Stainless steel.
Serrations and line cutter. 2 in 1 knife plus scissors function.



The length refers to the blade

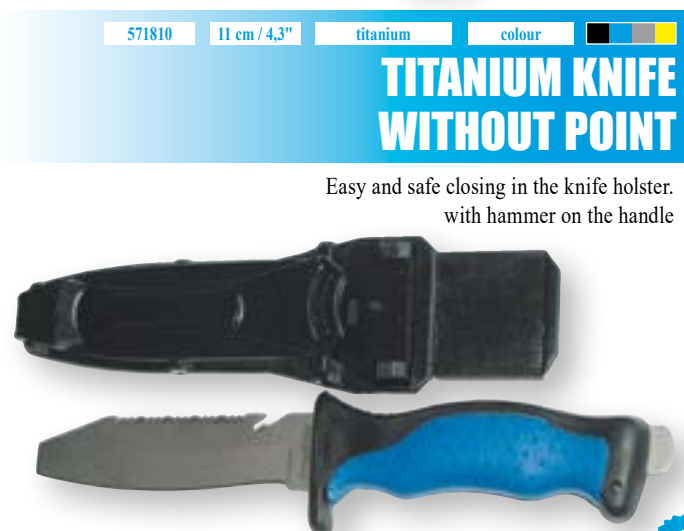

571321	11,5 cm / 4,5"	teflon surface	colour	■
--------	----------------	----------------	--------	---

SHARK UNIVERSAL

Multifunctional 420 Stainless steel blade. Also available with teflon surface.



571320				
--------	--	--	--	--

Mirror blade.

57183/B-Y	11,5 cm / 4,5"	titanium	colour	■ ■
-----------	----------------	----------	--------	-----

TITANIUM KNIFE



571930	8 cm / 3"	stainless steel	colour	■
--------	-----------	-----------------	--------	---

BC KNIFE

Blade material 304 S.S. Plastic sheath with BC hose mount. Attaches to BC or regulator hose.



571310	16 cm / 6,3"	stainless steel	colour	■ ■
--------	--------------	-----------------	--------	-----

DIVER'S UNIVERSAL KNIFE

High quality and professional design. 420 Stainless steel. Serrations and line cutter. 2 in 1 knife plus scissors function.

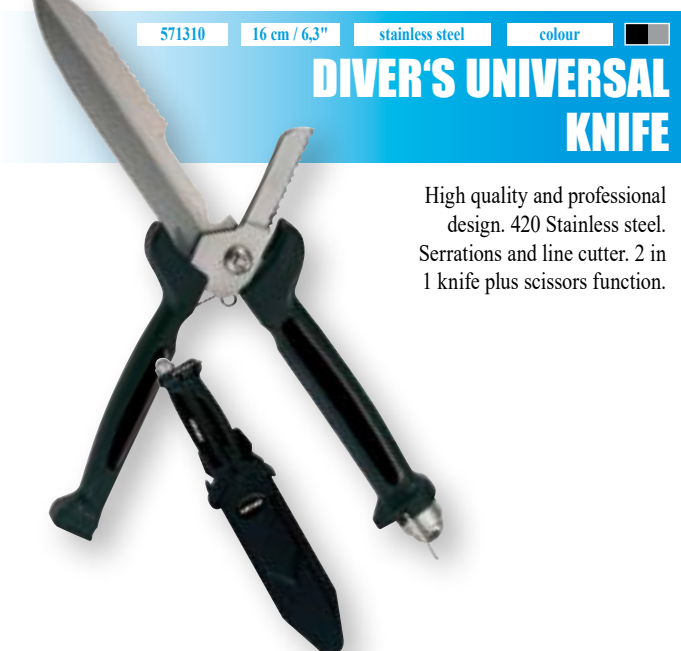

571700	6 cm / 2,4"	stainless steel	colour	■ ■
--------	-------------	-----------------	--------	-----

FOLDABLE KNIFE

In stainless steel or TITANIUM.



571710	6 cm / 2,4"	titanium	colour	■ ■
--------	-------------	----------	--------	-----

571330	11,5 cm / 4,5"	stainless steel	colour	■ ■
571331	11,5 cm / 4,5"	teflon surface	colour	■ ■

TORPEDO



AM6004	8 cm / 3"	stainless steel	colour	■
--------	-----------	-----------------	--------	---

RAPTOR KNIFE

Blade of 8cm (3") made of a 4mm thick high quality stainless steel grade 304. The overall length is 17cm (7")



57050/K, Y

9 cm / 3,5"

stainless steel

colour

**SHARK 9**

570700

8 cm / 3,2"

stainless steel

colour

**METAL SUB**

Multipurpose Jacket knife.



57110/K, Y

11 cm / 4,3"

stainless steel

colour

**SQUALO 11**

57060/K, Y

9 cm / 3,5"

stainless steel

colour

**SUB 9**

57030/K, Y

16 cm / 6,3"

stainless steel

colour



57031/K, Y

16 cm / 6,3"

teflon surface

colour

**SUB 16D**

57150/K, Y

LINE CUTTER

572022

7 cm / 2,8"

stainless steel

colour

**HEX KEYS
MULTIFUNCTION TOOL**

572021

stainless steel

colour

**8IN1 MULTIFUNCTION
DIVE TOOL**

572000

DIVE TOOL

57040/K, Y

11 cm / 4,3"

stainless steel

colour

**SUB 11**

164000

KNIFE HOLSTER

572100

KNIFE STRAP

LIFTING BAG



Lifting bag - 30 kg / 66 lb with valve (in nylon 240)	852610
Lifting bag - 50 kg / 110 lb with valve (in nylon 240)	852620
Lifting bag - 100 kg / 220 lb with valve (in nylon 240)	852630
Lifting bag - 30 kg / 66 lb	852611
Lifting bag - 50 kg / 110 lb	852621
Lifting bag - 100 kg / 220 lb with valve	852631
Lifting bag - 200 kg / 440 lb with valve	852640
Lifting bag - 500 kg / 1100 lb with valve	852650
Lifting bag - 500 kg / 1100 lb with double valve	852651
Lifting bag - 1000 kg / 2200 lb with valve	852660
Lifting bag - 1000 kg / 2200 lb with double valve	852661
Lifting bag - 1500 kg / 3300 lb Extra Strong with valve	852670
Lifting bag - 1500 kg / 3300 lb Extra Strong with double valve	852671
Lifting bag - 2000 kg / 4400 lb Extra Strong with valve	852680
Lifting bag - 2000 kg / 4400 lb Extra Strong with double valve	852681
Lifting bag - 2500 kg / 5500 lb Extra Strong with double valve	852685
Lifting bag - 3000 kg / 6600 lb Extra Strong with double valve	852686

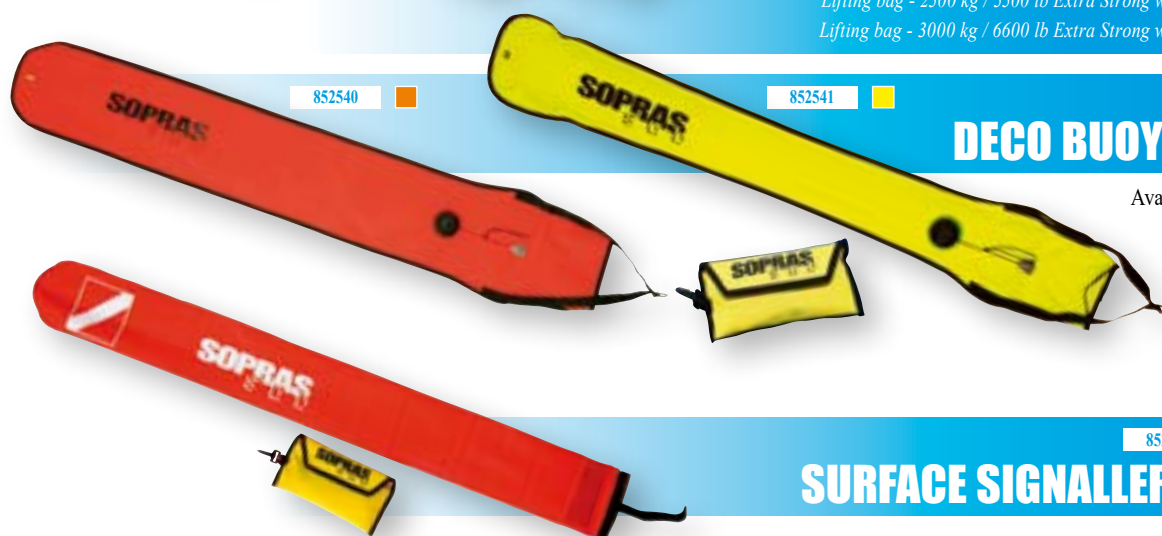

DECO BUOY WITH VALVE

Available in orange and yellow.

SURFACE SIGNALLER DECO BUOY



STANDARD BUOY

852510 40 x 45 cm / 17 x 19"



SMALL LEAD REEL

805026 50 m

For safety buoy.



SNORKELLING VEST

80722/0-3 size: S, M, L, XL



DIVE FLAG

852535 35 x 40cm / 14" x 16"



805010	30 m / 100 ft
805020	50 m / 165 ft

STANDARD SPOOL



805110	30m/100ft
805112	45m/150ft

ANATOMIC REEL



805100	20m/66ft
805104	30m/100ft
805108	50m/165ft

ANATOMIC SPOOL



805000	50 m / 165 ft
--------	---------------

PLASTIC REEL WITH AUTO STOP



805011	20 m / 66 ft
805012	30 m / 100 ft
805013	50 m / 165 ft

STAINLESS STEEL SPOOLS



80480/B, S	45 m / 150 ft	colour	
80490/B, S	82 m / 273 ft	colour	

ALUMINIUM REEL



DUAL AIR HOSE HOLDER WITH CLIP

80130/K, Y, B	colour:	
---------------	---------	--



TRIPLE AIR HOSE HOLDER WITH CLIP

80133/K, Y, B	colour:	
---------------	---------	--



am6053	90 cm / 36"
--------	-------------

RETRACTOR WITH STOP



am6051	90 cm / 36"
--------	-------------

RETRACTOR

WEIGHTS AND BELTS



805300	1kg	colour	■
805310	2kg	colour	■
805320	3kg	colour	■

SOFT LEAD WEIGHTS



804310	5 x 150 cm / 2 x 59"	colour	■
--------	----------------------	--------	---

WEIGHT BELT WITH PLASTIC BUCKLE



804210	S	804230	L
804220	M	804240	XL

DIVING BELT WITH POCKET FOR WEIGHTS



80401K

WEIGHT BELT KEEPER



80541/K, Y, B	1kg	colour	■ ■
80542/K, Y, B	2kg	colour	■ ■

LEAD WEIGHTS FOR BELT WITH PLASTIC COATING



804400

PLASTIC BUCKLE



240316

WEIGHT POCKET FOR TANK STRAP

Weight pocket to be attached to the tanks straps (maximum weight 4kg each)



760900

DIN REGULATOR DUST CAP



760905

DUST CAP FOR VALVES



760910

DIN REGULATOR DUST CAP

In aluminium



760915

DUST CAP FOR VALVES

In aluminium



804700

UNDERWATER WRIST SLATE



851710

FILLING FOR SOPRASSUB DIVE LOG



804750

WRITING WRIST SLATE

with common messages



80670/Y,B

HOSE WRAP

Available in yellow and blue.



851700

DIVE LOG ORGANIZER

Made of 420denier PU.



804600

UNDERWATER SLATE



805600

TANK BANGER



852120

JONLINE



760400

HOSE PROTECTOR



852122

95 cm

REEF HOOK



852121

HOOK FOR JONLINE

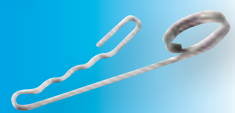

801110

200 ml

SILICONE SPRAY



806000

WHISTLE



801100

SILICONE GREASE 60g



807100

DIVE REPAIR KIT



807200

SHAKER

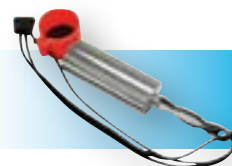

With magnet inside.

807150

length 35 cm

UNDERWATER STICK

Good for pointing or for anchoring in strong currents.

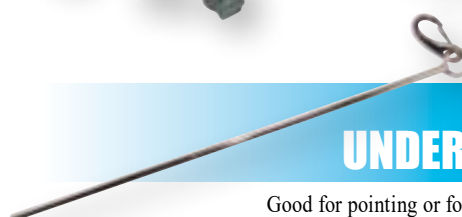

807210

with 20 cm stick

RATTLE WITH POINTER

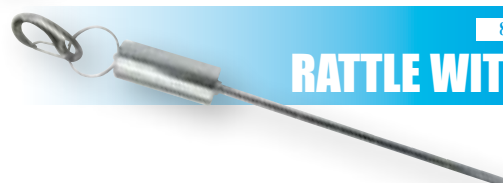

ACCESSORIES



803001

**WEBBING
AND BUCKLE code 01**



803008

**WEBBING AND
BUCKLE code 08 elastic**



803002

**WEBBING
AND BUCKLE code 02**



803004

**WEBBING
AND BUCKLE code 04**



803011

**WEBBING
AND BUCKLE code 11**



803005

**WEBBING
AND BUCKLE code 05**



802410

**SPIRAL SPRING CLIP
WITH LOOP CORD**



802400

**SPIRAL
SPRING CLIP**



80242B/K

**QUICK RELEASE
COIL LANYARD**

With high quality snap hook.



803007

**WEBBING
AND BUCKLE code 07**

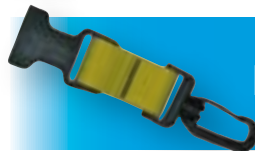

802600

**PLASTIC CLIP
LINK FEMALE**



803009

**WEBBING
AND BUCKLE code 09**



803010

**WEBBING
AND BUCKLE code 10**



802500

**PLASTIC CLIP
LINK MALE**



803012

**WEBBING
AND BUCKLE code 12**



803003

**WEBBING
AND BUCKLE code 03**



803006

**WEBBING
AND BUCKLE code 06**



801500 80 mm / 3.1"

**INOX SPRING - clip
with side opening**

80400/K,Y,R colour

**NYLON WEIGHT
KEEPER**



802100 80mm / 2.8"

**BRONZE SPRING
- clip with pulley**



801501 100 mm

**S.S. 316
CARABINER**



802000 80 mm / 3"

**ALUMINIUM
SPRING**



80680/K, B, Y colour

MULTIPURPOSE HANGER



801900 50 mm / 2"

**ALUMINIUM
SPRING**



806811

**HANGER II BLACK
FOR SUITS**



80681K

80681Y

**MULTIPURPOSE
HANGER II**

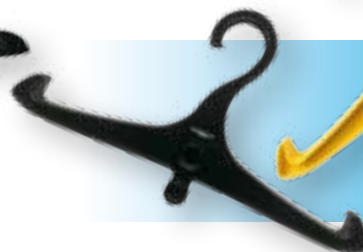

DRY BAGS AND BOXES



852410	80 l / 176 lb
852415	60 l / 132 lb
852420	40 l / 88 lb
852425	20 l / 44 lb

WATERPROOF BAG



852430 40 l / 88 lb

WATERPROOF BACKPACK



852440 60 l / 132 lb

WATERPROOF TRAVEL BAG



852455

WATERPROOF LADY HAND BAG



806310

46 x 34 x 20 cm / 18 x 13 x 8"

colour



HEAVY DUTY DRY BOX

With foam to create your own compartments.

806321

21 x 13,5 x 8 cm / 8 x 5 x 3"

colour



DRY BOX SMALL



806311

23 x 16,5 x 11,5 cm / 9 x 6,5 x 4,5"

colour



DRY BOX MEDIUM



806300

10 x 7 cm / 4 x 3"

DRY BOX - EXTRA SMALL



BAGS

851501

86 x 37 x 33 cm / 34x15x13"

PVC Dobby Nylon

600 D

80 l / 176 lb

TRAVEL BAG

Light weight (only 2.2kgs) and very large travel bag with wheels.



852110

11 x 8 cm / 4 x 3"

BAG FOR COMPASSES



852100

10 x 8 cm / 4 x 3"

BAG FOR WATCHES



851800

COMPUTER AND GAUGES BAG



851900

30 x 16,5 x 11,5 cm / 11 x 6,5 x 4,5"

BAG FOR CONSOLES



851502

55 x 70 x 30 cm / 22x28x12"

PVC

600 D

110 l / 240 lb

SOPRAS DIVING TROLLEY



Our new trolley includes a detachable back pack in the front and two big bags for fins on the sides. On the bottom there is a handle for easy carrying that ensures also perfect stability when standing vertical on wheels. One side handle makes it much easier to carry it. Light weight - 3,5kg only.





851150 420 denier 63 x 49 cm / 25 x 20"
PU 50 l colour

MESH BAG FOR JACKETS AND SUITS



851400 420 denier 80 x 40 cm / 31 x 16"
PU 60 l colour

MESH GEAR BAG



851000 840 D 43 x 33 cm / 18 x 12" PVC colour

BRIEF CASE



Multi function with inside pocket, shoulder strap and handle.

CY1100 840 D 43 x 33 cm / 18 x 12" colour

CYCLING BACKPACK



20 litres volume cycling backpack with fluo rain cover, waist strap, earphones pre-disposition, thick polstering on the back and padded shoulder straps, many zipper pockets and equipment compartments.



851200 420 denier 43 x 64 cm / 18 x 25" PU colour

FOLDABLE MESH BACK PACK



852200 840 D 38 x 15 x 12 cm / 18 x 25" PVC Dobby Nylon colour

WAIST BAG



Zipper: #8 Chunky zipper
Buckles: plastic Buckles.

CY1200 30 x 50 x 20 cm / 12 x 20 x 8"
nylon 210D colour

CYCLING BACKPACK



Extra light expandable cycling backpack, includes a fluo water-proof cover.

 **soprassub**
www.soprassub.com

Diveproduction s.r.o.
Cerveny Ujezd 267, 273 51 Unhost
Czech Republic
diving@sopras.cz
Tel.: +420 312 699 790
Fax.: +420 312 699 792



 **soprasapnea**
www.soprasapnea.com



 **soprastek**
www.soprastek.com

Webshop for USA and Canada **www.soprassubusa.com**